

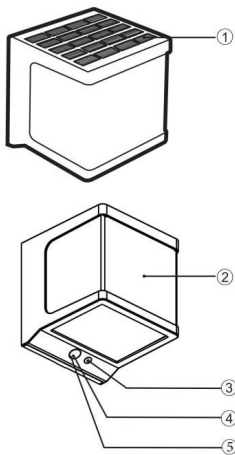

Main Parts



- ① Solar panel
- ② Lampshade
- ③ Switch
- ④ PIR
- ⑤ Indicator light

Electrical Characteristics:

Solar panel: Monocrystalline
Rechargeable Battery: Li-ion Battery
Material: ABS & PC

**How to install
the device?**

Fix the lamp on the wall with the screws.

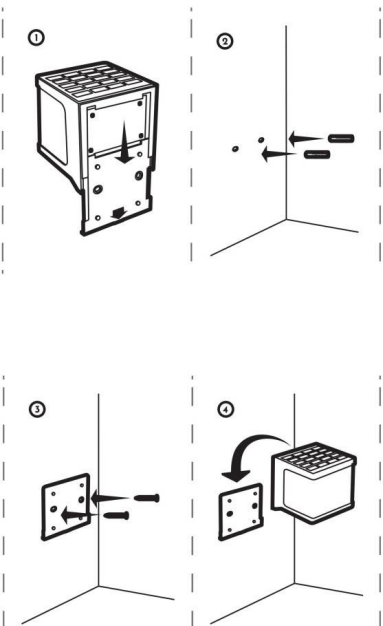

Keep the solar panel face the sunlight directly to ensure it
can charge the inside Li-ion battery effectively

**Working
process
instructions**

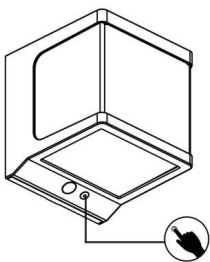

Switch
Press 1.5S for ON/OFF
Short press to change the lighting mode

Lighting mode indicator
Red LED :
M1: Blink one time
M2: Blink two times
M3: Blink three times

Lighting mode
M1: 100LM+PIR 1000LM(10S)
M2: 0+PIR 1000LM(10S)
M3: 300LM 6H