



- Installation and wiring of luminaire must be in accordance with all applicable local codes.
- Installation, inspection, and maintenance of luminaires should be performed by a qualified electrician.
- DO NOT make or alter any open holes in the luminaire. Do not modify the luminaire.
- DO NOT install damaged product.
- Make sure electrical power is OFF before and during installation and maintenance.
- Make sure the equipment is properly grounded.
- Make sure the supply voltage is same as the rated fixture voltage.

**Tracking and luminaire:**  
First trunking rail should have one side connecting plate & last trunking rail with no connecting plate on both sides, then fix the Luminaire to trunking rail then lock holder, then keep end caps at both sides.

**8-core trunking rail**

|     |    |   |    |    |    |      |      |
|-----|----|---|----|----|----|------|------|
| ①   | ②  | ③ | ④  | ⑤  | ⑥  | ⑦    | ⑧    |
| CHR | L1 | N | L2 | PE | L3 | DIM+ | DIM- |
| CHR | L1 | N | L2 | PE | L3 | DA/L | DA/N |
| CHR | L1 | N | L2 | PE | L3 | EL1  | EN1  |

**12-core trunking rail**

|     |    |    |    |    |    |      |      |     |     |     |     |
|-----|----|----|----|----|----|------|------|-----|-----|-----|-----|
| ①   | ②  | ③  | ④  | ⑤  | ⑥  | ⑦    | ⑧    | ⑨   | ⑩   | ⑪   | ⑫   |
| CHR | L1 | N  | L2 | PE | L3 | DIM+ | DIM- | EL1 | EN1 | EN2 | EL2 |
| CHR | L1 | N  | L2 | PE | L3 | DA/L | DA/N | EL1 | EN1 | EN2 | EL2 |
| CHR | L1 | N1 | L2 | PE | L3 | DM+  | DM-  | L4  | N2  | L5  | L6  |

**5-core trunking rail** ① ② ③ ④ ⑤

|    |   |    |    |    |
|----|---|----|----|----|
| L1 | N | L2 | PE | L3 |
|----|---|----|----|----|

**10** Definition of 5-core 8-core and 12-core trunking rail

**1** Trunking Rail  
**2** Connecting plate  
**3** Power cable feed in hole  
**4** Luminaire  
**5** Driver  
**6** Lock holder  
**7** Male connector  
**8** Female connector  
**9** Installation cord

**Step 1** Mounting Suspension  
Adjust length of suspension cord:  
a. press down Hexagon bolt;  
b. Pull in/out cord to adjust length

**Step 2** Connecting Power Supply  
Put in conduit with cable inside and pull up conduit gland to lock

**Step 3** Connecting Trunking Rail  
Both trunking rails should keep in perfect position then push to click

**Step 4** Mounting Luminaire  
Click in mounting clip into trunking rail  
Slide knob to select phase L1/L2/L3

**Step 5** LED linear lighting system

Including luminaires  
Including luminaires and sensor  
Including luminaires and spotlight  
Including luminaires and black cover

Make sure male & female connectors in right position then fix the luminaire to trunking rail

Connect wires according labeling on wires to feed in connector then connect to connector in trunking rail

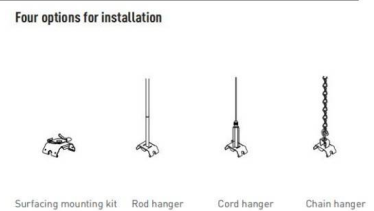
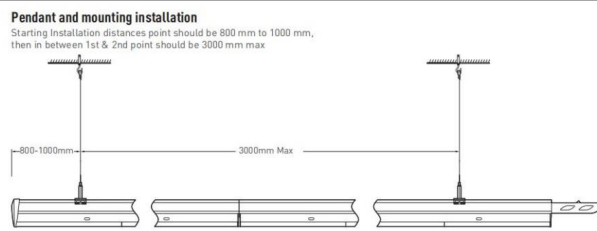
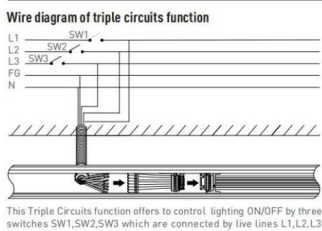

Safety notes:  
Installation should be performed only by qualified electrician.

- Make sure no voltage while installation.
- Connect cable wires according to wire labeling.
- Max current should not exceed 16A in one power feed in circuit.

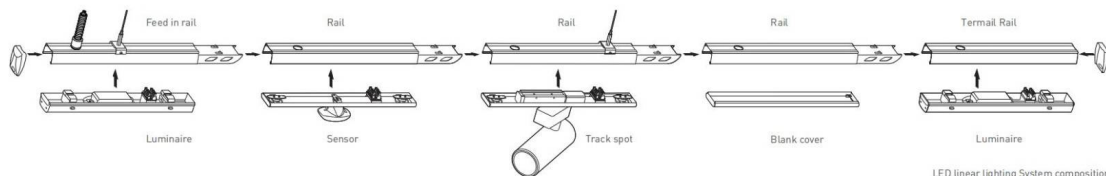

**Terminal module:**

Terminal module can be independently installed as a single unit, it also can be connected at end of one linear light row.

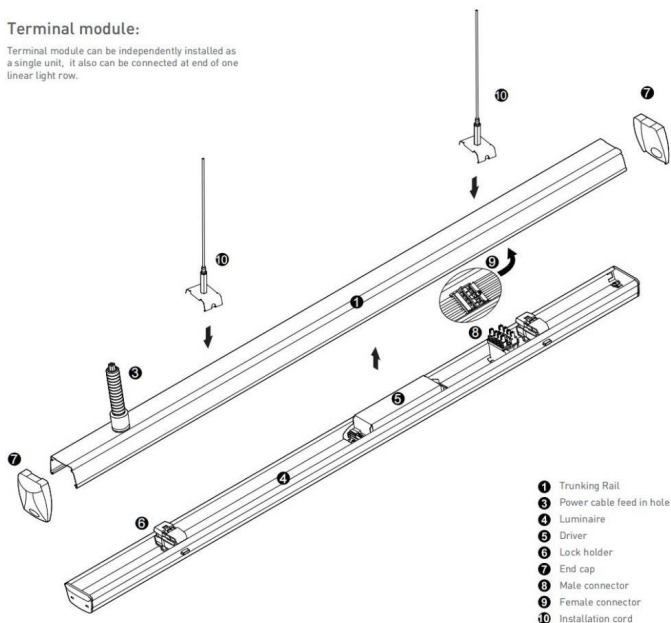

**Step 1**  
Mounting Suspension

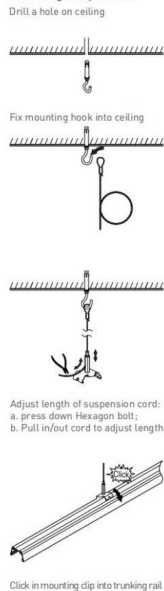

**Step 2**  
Connecting Power Supply

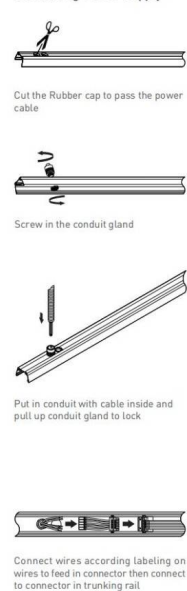

**Step 3**  
Mounting Luminaire

