

- Installation and wiring of luminaire must be in accordance with all applicable local codes.
- Installation, inspection, and maintenance of luminaires should be performed by a qualified electrician.
- DO NOT make or alter any open holes in the luminaire. Do not modify the luminaire.
- DO NOT install damaged product.
- Make sure electrical power is OFF before and during installation and maintenance.
- Make sure the equipment is properly grounded.
- Make sure the supply voltage is same as the rated fixture voltage.

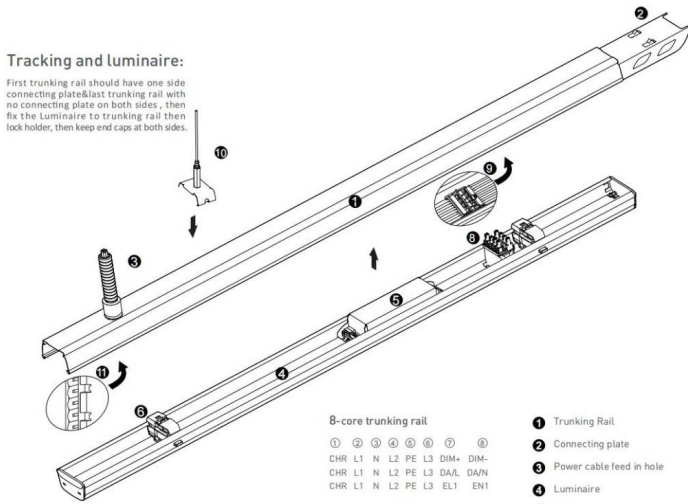

**Tracking and luminaire:**

First trunking rail should have one side connecting plate&last trunking rail with no connecting plate on both sides, then fix the Luminaire to trunking rail then lock holder, then keep end caps at both sides.



**8-core trunking rail**

① ② ③ ④ ⑤ ⑥ ⑦ ⑧  
CHR L1 N L2 PE L3 DIM+ DIM-  
CHR L1 N L2 PE L3 DA/L DA/N  
CHR L1 N L2 PE L3 EL1 EN1

**12-core trunking rail**

**Definition of 5-core 8-core and 12-core trunking rail**

5-core trunking rail ① ② ③ ④ ⑤  
L1 N L2 PE L3

① ② ③ ④ ⑤ ⑥ ⑦ ⑧ ⑨ ⑩ ⑪ ⑫  
CHR L1 N L2 PE L3 DIM+ DIM- EL1 EN1 EN2 EL2  
CHR L1 N L2 PE L3 DA/L DA/N EL1 EN1 EN2 EL2  
CHR L1 N1 L2 PE L3 DA/L DA/N L4 N2 L5 L6

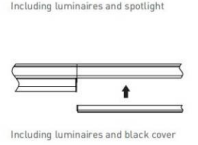
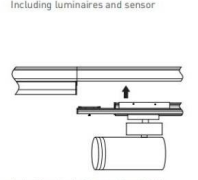
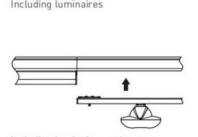
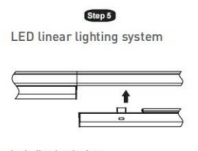
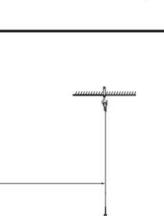
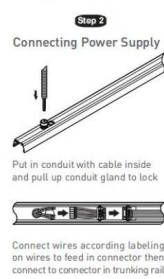
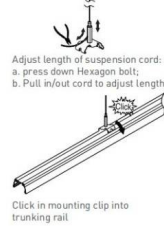
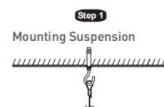

**Wire diagram of triple circuits function**

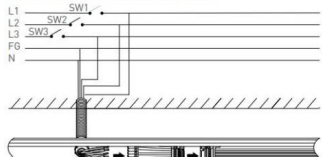

This Triple Circuits function offers to control lighting ON/OFF by three switches SW1,SW2,SW3 which are connected by live lines L1,L2,L3

**Pendant and mounting installation**

Starting Installation distances point should be 800 mm to 1000 mm, then in between 1st & 2nd point should be 3000 mm max

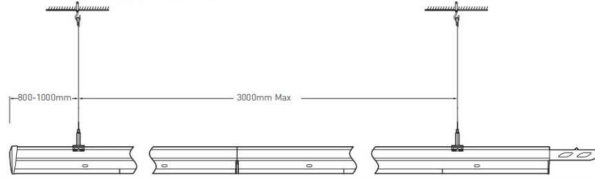

**Four options for installation**



Safety notes:  
Installation should be performed only by qualified electrician.

- Make sure no voltage while installation.
- Connect cable wires according to wire labeling.
- Max current should not exceed 16A in one power feed in circuit.

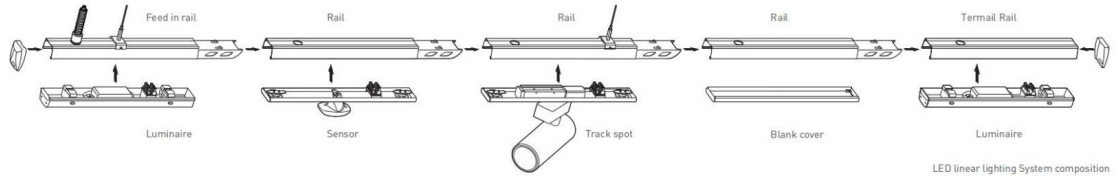

LED linear lighting System composition

**Terminal module:**

Terminal module can be independently installed as a single unit, it also can be connected at end of one linear light row.

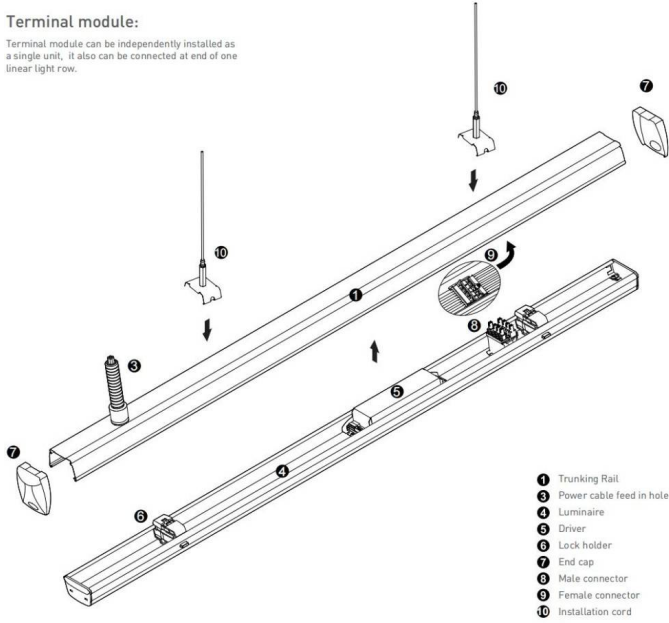

- 1 Trunking Rail
- 2 Power cable feed in hole
- 4 Luminaire
- 5 Driver
- 6 Lock holder
- 7 End cap
- 8 Male connector
- 9 Female connector
- 10 Installation cord

