



**ING-MINI**

Recessed Inground Floor from the family ING-MINI with a power of 6,7W and a beam angle of 24 degrees. with a real lumen output of 442 lm, and an efficiency of 65,97 lm/W, made in Die Cast Aluminium Body, Front Ring Stainless Steel. , Tempered Glass Cover and finished in Stainless Steel. ON-OFF driver.

<b>Item code</b>	<b>86.OIN1.1321.07</b>
<b>Product type</b>	<b>Outdoor</b>
<b>Category</b>	<b>Recessed Inground Floor</b>
<b>Family</b>	<b>ING</b>
<b>Subfamily</b>	<b>ING-MINI</b>

**Pictograms**

**Product**

<b>Real power (W)</b>	<b>6.7</b>
<b>Real luminous flux (Lm)</b>	<b>442</b>
<b>Luminous efficiency (Lm/W)</b>	<b>65.97</b>
<b>Beam angle (°)</b>	<b>24</b>
<b>Life time (h)</b>	<b>50000h L80B10</b>
<b>IP</b>	<b>67</b>
<b>Electrical class insulation</b>	<b>Class I</b>
<b>Colour</b>	<b>Stainless steel</b>
<b>Control gear included</b>	<b>Yes</b>
<b>Control gear</b>	<b>ON-OFF</b>
<b>Light source</b>	<b>1x5W COB</b>
<b>Colour temperature (K)</b>	<b>3000</b>
<b>Colour consistency (SDCM)</b>	<b>SDCM&lt;3</b>
<b>CRI</b>	<b>80</b>
<b>IK</b>	<b>07</b>

**Scheme**

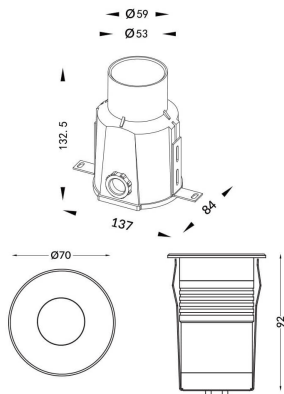

**Photometry**

