

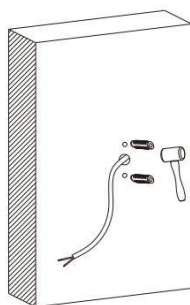

- Installation and wiring of luminaire must be in accordance with all applicable local codes.
- Installation, inspection, and maintenance of luminaires should be performed by a qualified electrician.
- DO NOT make or alter any open holes in the luminaire. Do not modify the luminaire.
- DO NOT install damaged product.
- Make sure electrical power is OFF before and during installation and maintenance.
- Make sure the equipment is properly grounded.
- Make sure the supply voltage is same as the rated fixture voltage.

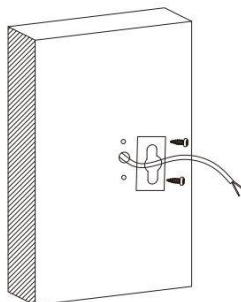

Drill two holes on the wall where you are about to install the lighting fixture. Then put two rubber plug into the holes respectively by using a hammer.



Fix the back cover of the bracket on the wall with two steel screw. Make sure the cable get through the hole in the middle of it.

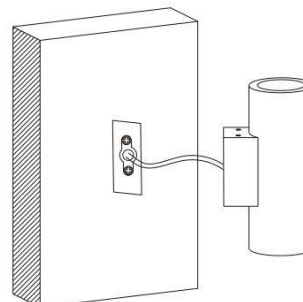

Connect the lighting fixture with the cable which is been prepared for the installation previously.

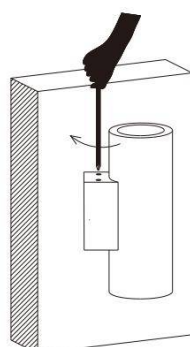

Fix the fixture on the back cover of the bracket with four screw

Low voltage single color fitting: use external power supply, the input voltage of power supply must be consistent with the requested input voltage of the fitting, as the fitting is constant voltage input type. The power consumption of power supply must be decided by installer according to the requirements from the site.

Example of wiring:

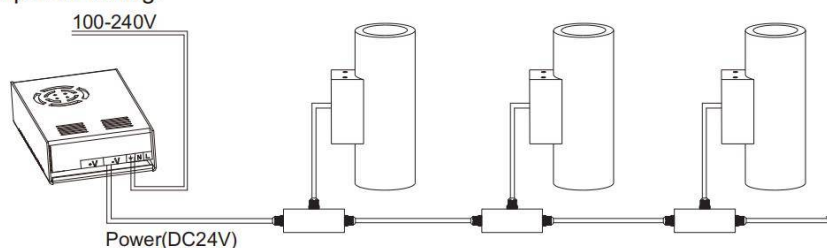

24VDC: circuit of product

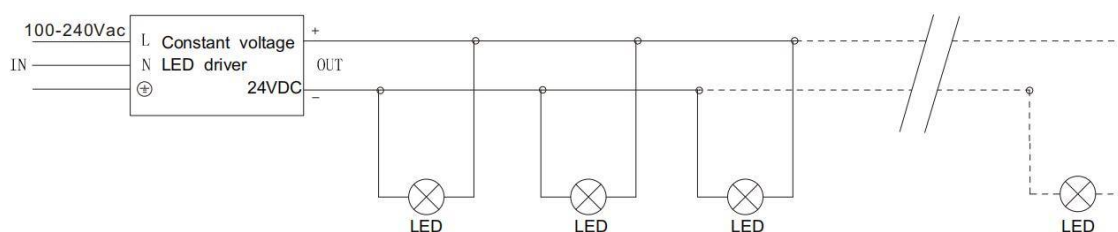

Explanations: the transmiss circuit of the whole group depends on the circuit of junction boxes. the max. current depends on the max. load of power cable between the junction box, but it is not related to the max. load current of power cable of the fitting. The outer diameter of cable between the junction boxes is limited by the max. outer diameter of speedy plug, the max. allowed outer diameter is 10mm.