

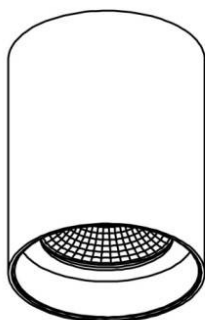

## Installation Instruction



### CAUTIONS:

1. Switch-off the power supply before any installation and maintenance operations.
2. Installation should be carried out by a suitably qualified person in accordance with good electrical practice and the appropriate national wiring regulations.
3. Connect this lighting according to voltage and frequencies mention on driver.

### INSTALLATION:

#### 1 Make a hole

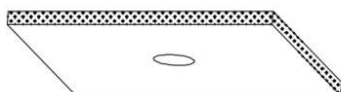

#### 2

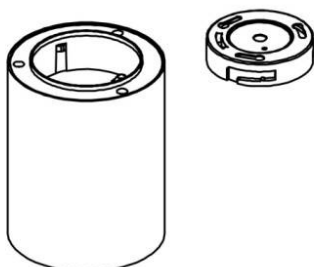
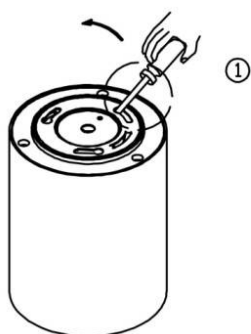

#### 3

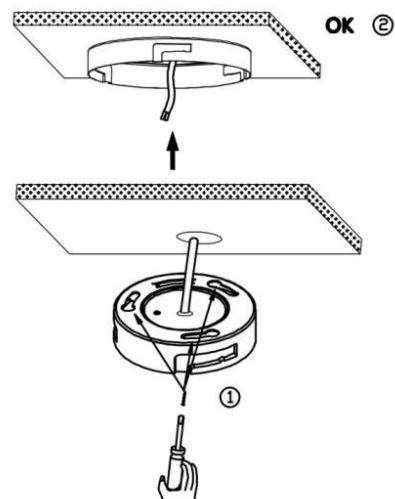

#### 4

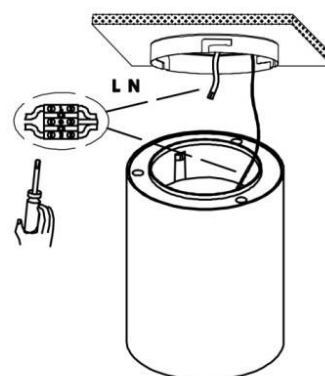

#### 5

